

Schottky Barrier Rectifiers

Using the Schottky Barrier principle with a Molybdenum barrier metal. These state-of-the-art geometry features epitaxial construction with oxide passivation and metal overlay contact. Ideally suited for low voltage, high frequency rectification, or as free wheeling and polarity protection diodes.

- * Low Forward Voltage.
- * Low Switching noise.
- * High Current Capacity
- * Guarantee Reverse Avalanche.
- * Guard-Ring for Stress Protection.
- * Low Power Loss & High efficiency.
- * 150 Operating Junction Temperature
- * Low Stored Charge Majority Carrier Conduction.
- * Plastic Material used Carries Underwriters Laboratory Flammability Classification 94V-O

Plating pb free is indicated by box

MAXIMUM RATINGS

Characteristic	Symbol	SR					Unit
		302	303	304	305	306	
Peak Repetitive Reverse Voltage Working Peak Reverse Voltage DC Blocking Voltage	V_{RRM} V_{RWM} V_R	20	30	40	50	60	V
RMS Reverse Voltage	$V_{R(RMS)}$	14	21	28	35	42	V
Average Rectifier Forward Current	I_O	3.0					A
Non-Repetitive Peak Surge Current (Surge applied at rate load conditions half-wave, single phase, 60Hz)	I_{FSM}	100					A
Operating and Storage Junction Temperature Range	T_J, T_{STG}	-65 to +150					

ELECTRIAL CHARACTERISTICS

Characteristic	Symbol	SR					Unit
		302	303	304	305	306	
Maximum Instantaneous Forward Voltage ($I_F = 3.0$ Amp) ($I_F = 9.0$ Amp)	V_F	0.550 0.850		0.650 0.950		V	
Maximum Instantaneous Reverse Current (Rated DC Voltage, $T_C = 25$) (Rated DC Voltage, $T_C = 125$)	I_R	0.5 20				mA	
Typical Junction Capacitance (Reverse Voltage of 4 volts & $f=1$ MHz)	C_P	210		190		pF	

SCHOTTKY BARRIER RECTIFIERS

**3.0 AMPERES
20-60 VOLTS**



DO-201AD

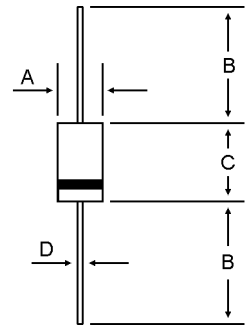

DIM	MILLIMETERS	
	MIN	MAX
A	5.00	5.60
B	25.40	---
C	8.50	9.50
D	1.20	1.30

CASE---
Transfer molded plastic

POLARITY---
Cathode indicated polarity band

SR302 Thru SR306

FIG-1 FORWARD CURRENT DERATING CURVE

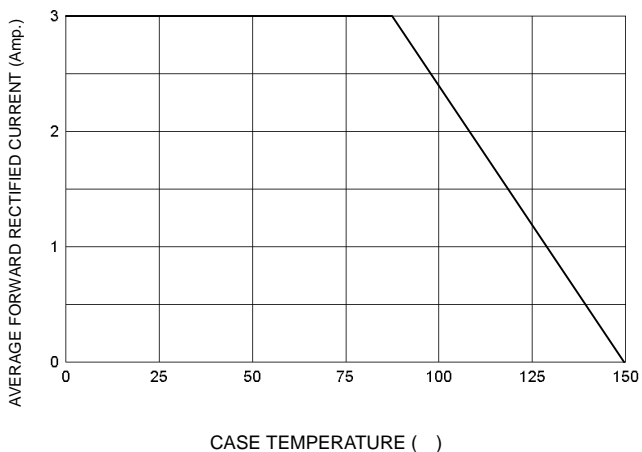

FIG-2 TYPICAL FORWARD CHARACTERISTICS

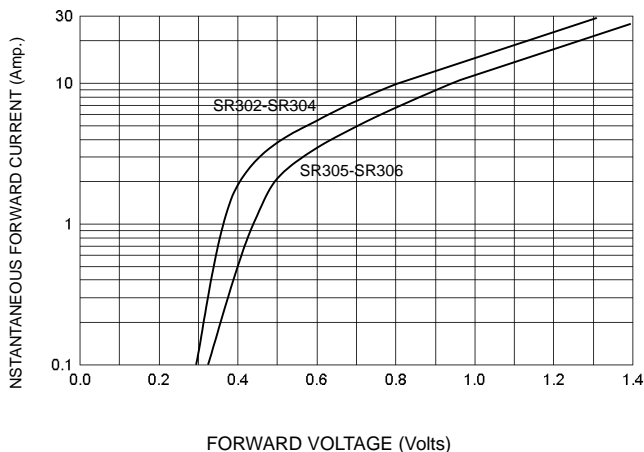

FIG-3 TYPICAL REVERSE CHARACTERISTICS

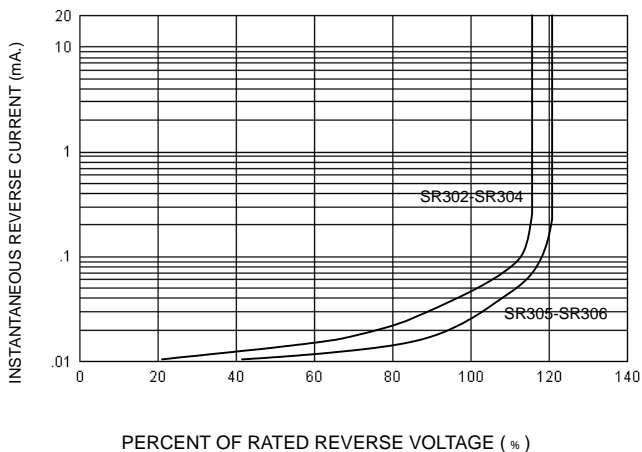

FIG-4 TYPICAL JUNCTION CAPACITANCE

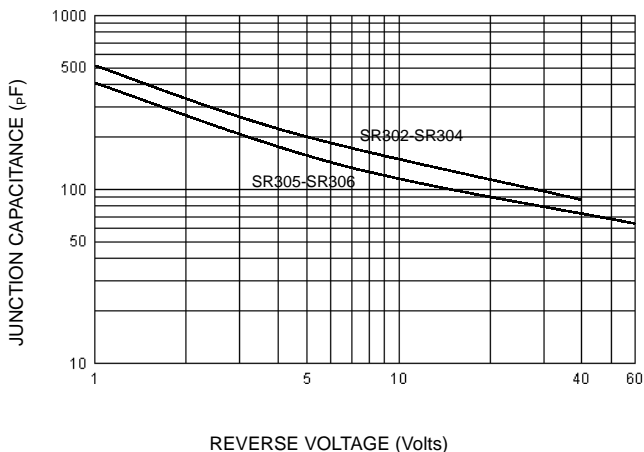
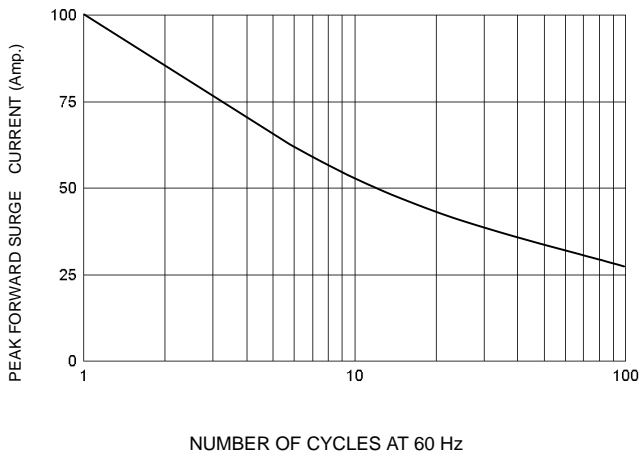
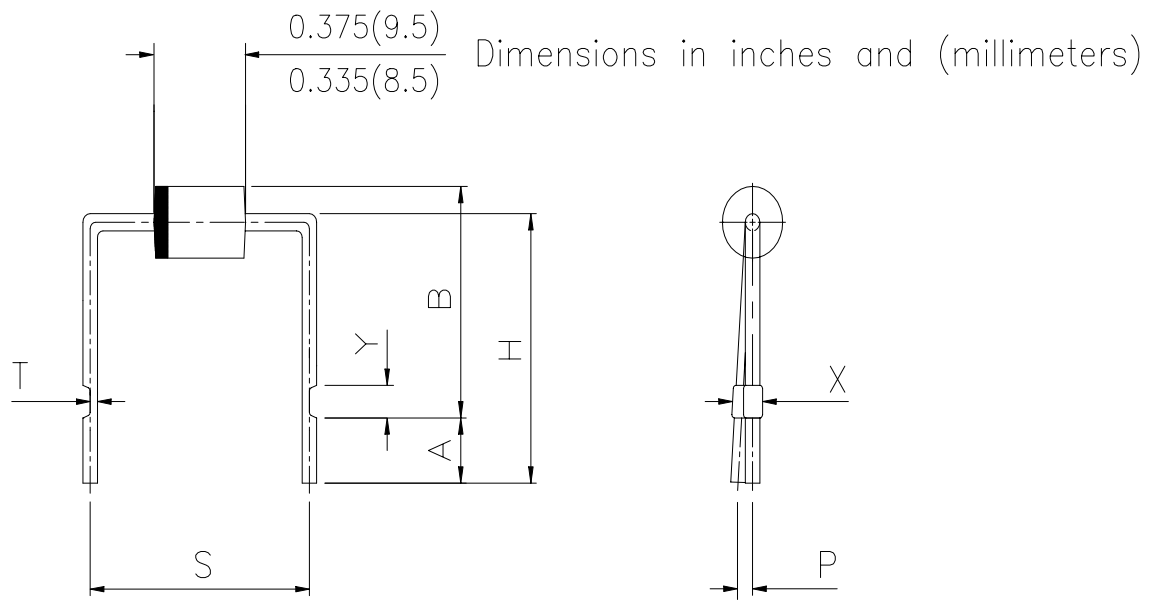

FIG-5 PEAK FORWARD SURGE CURRENT





Code	S	H	A	B	Y	T	X	P
22C-427	20.0±1.0	21.0±1.0	4.0±0.5	19.0±0.5	2.0±0.5	0.6±0.2	2.0±0.3	1.5 Max